



BAGUETTE SLICER CP-250

Cuts up to 16,800 slices of stick/french bread per hour.



✓ Height: 910 mm

External dimensions with stand

✓ Width with stand: 494 mm

✓ Depth with stand: 567 mm

✓ Height with stand: 1530 mm

Net weight: 28.2 kg

Noise level (1m.): <75 dB(A)

Crated dimensions

440 x 560 x 600 mm

Gross weight: 31.6 kg

AVAILABLE MODELS

1050225 Bread slicer CP-250 230/50/1

1050228 Bread slicer CP-250 220/60/1

1050250 BREAD SLIC PAN CP-250 120/60/1

* Ask for special versions availability

SALES DESCRIPTION

Slice thickness: 20 to 90 mm.

This French bread cutter machine cuts 8.400/16.800 slices of stick bread per hour, inserting 1 or 2 loaves of bread per operation.

- ✓ To slice bread loaves in adjustable thickness.
- ✓ Feeding mouth with capacity for one or two bread loaves.
- ✓ Ideal for restaurants, "tapas" bars and big communities.
- ✓ Stainless steel made.
- ✓ Economy: quick to operate, uniform slice thickness and minimal waste.
- ✓ Hygiene, as operator has less contact with the product.
- ✓ Easy to clean.
- ✓ Removable blade.
- ✓ Safety system at cover and hand protecting grid at bread outlet.
- ✓ Optional: stainless steel stand.

OPTIONAL

- Stainless steel stand.

SPECIFICATIONS

Slice production: 8400 / 16800

Slice thickness: 20 mm - 90 mm

Total loading: 250 W

Mouth dimensions: 115 mm x 135 mm

Electrical supply: 230 V // 1~

External dimensions (W x D x H)

✓ Width: 410 mm

✓ Depth: 524 mm



DYNAMIC PREPARATION
BAGUETTE SLICERS

product sheet
updated 20/01/2024



BAGUETTE SLICER CP-250

Cuts up to 16,800 slices of stick/french bread per hour.



DYNAMIC PREPARATION
BAGUETTE SLICERS

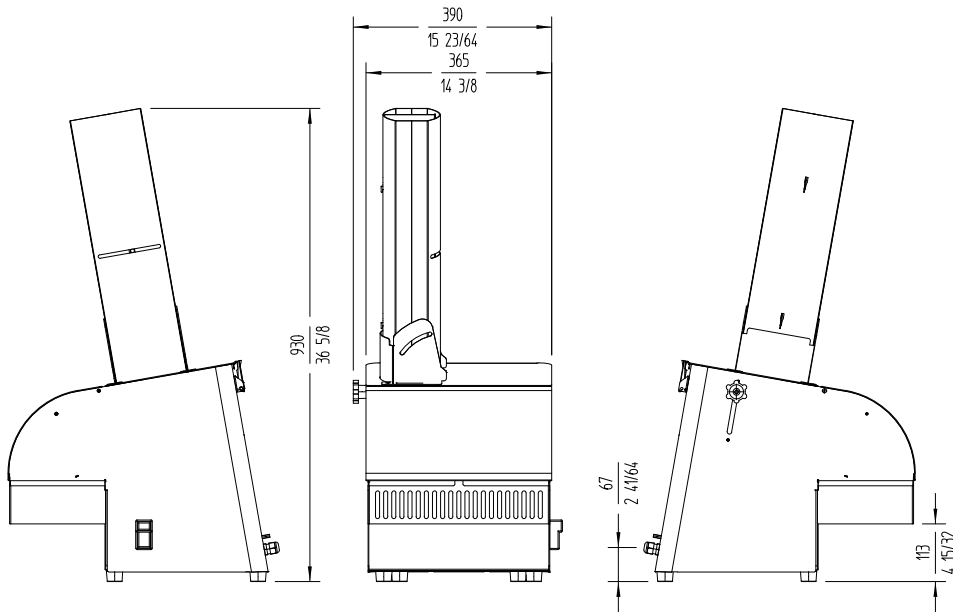

www.sammic.co.uk

Food Service Equipment Manufacturer

Unit 2, Trevanth Road
Troon Industrial Park
LE4 9LS - Leicester

uksales@sammic.com
Tel.: +44 0116 246 1900



Project	Date
---------	------

Item	Qty
------	-----

Approved	
----------	--

product sheet
updated 20/01/2024